

Dearden Fold





Dearden Fold Farm is an early form of Hall House (a grade II* listed building), its original three trusses, two associated with the hall and one with a cross-wing survive. Dendrochronological analysis of the oak timbers (by the Ancient Monuments Laboratory in 1998, which became part of English Heritage now Historic England) indicate that it was built in 1488. This was during the reign of Henry VII and it is probably the oldest building in Ainsworth.

Figure 1 Plan of Dearden Fold Farmhouse showing location of surviving trusses (after Corbett 1993), and numbering used in this report

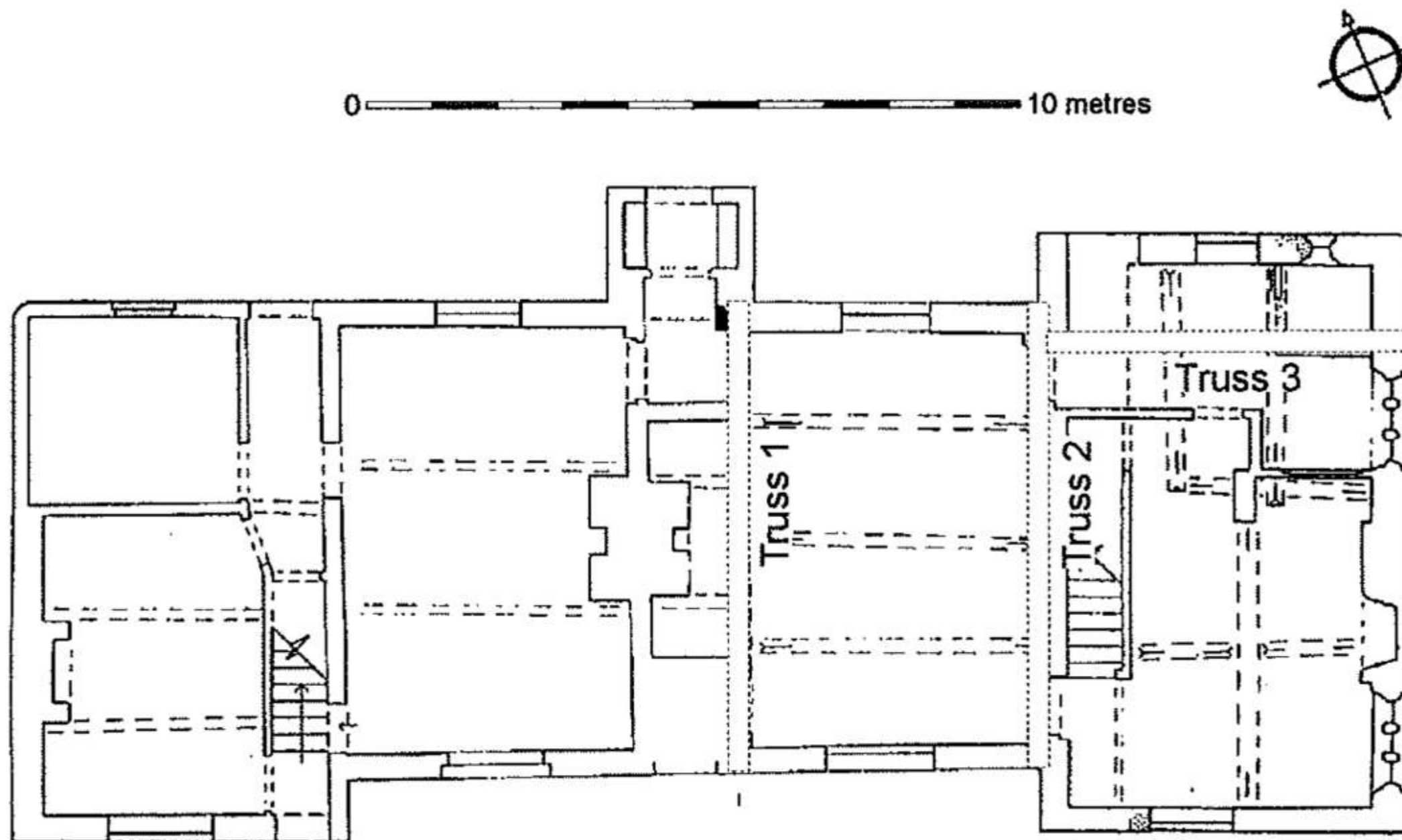



0 10 metres

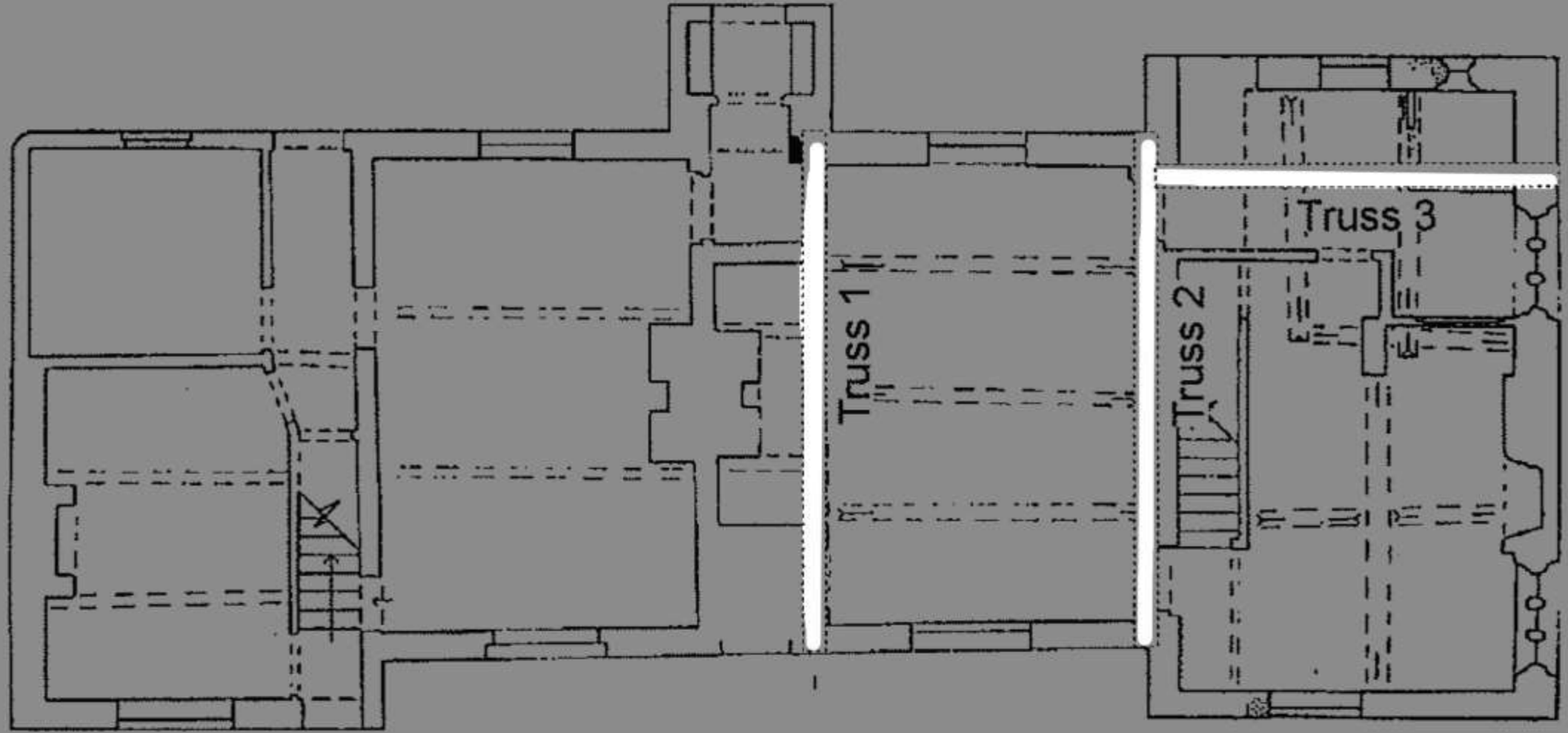

It could date back to as early 1397, often timber was left to season. Some of the timbers retain their bark.



This is a picture of what
Dearden Fold may have been
like inside.



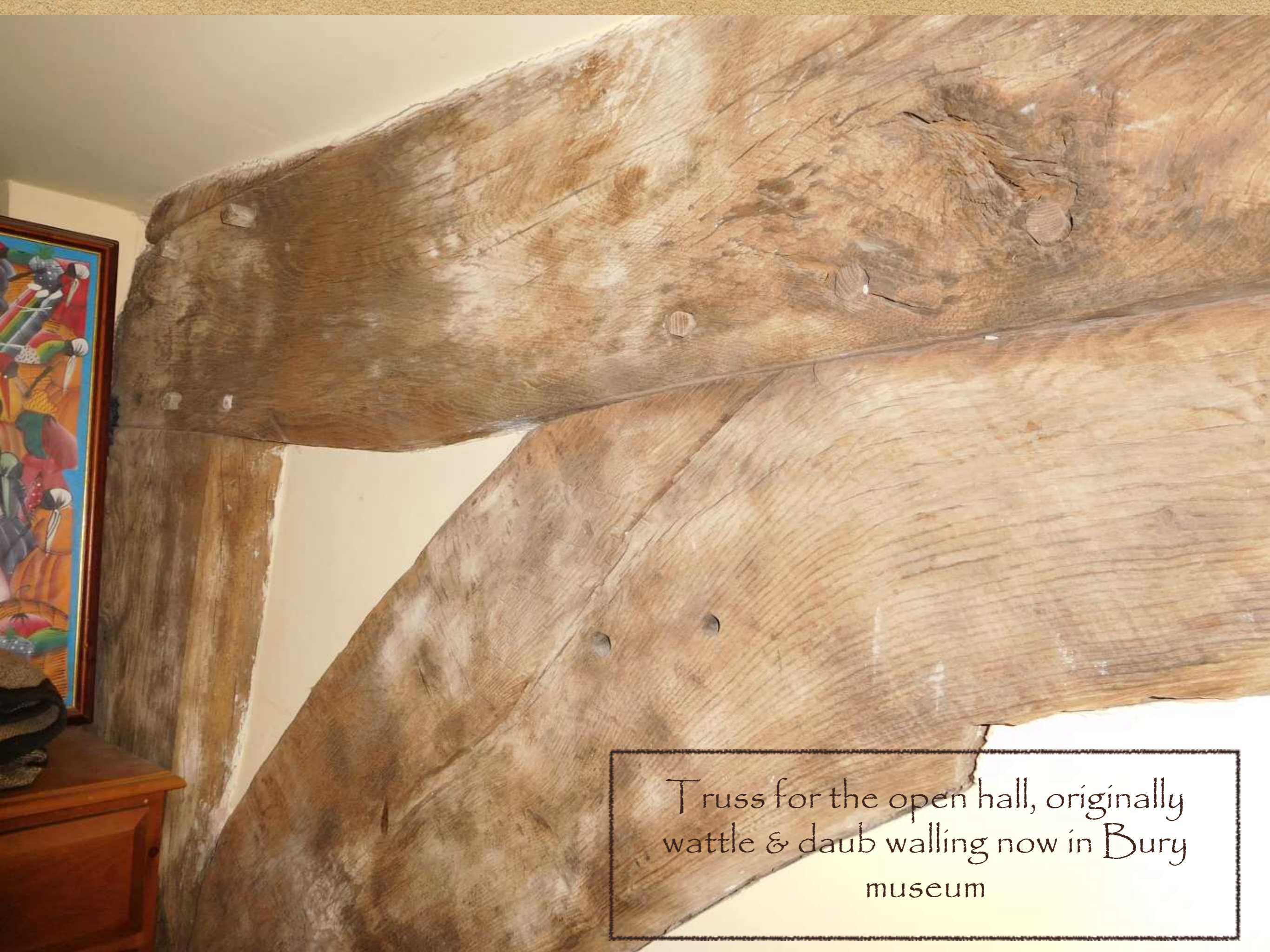

Truss for the open hall, originally
wattle & daub walling now in Bury
museum



East Wall
Trust













Cellar







There is no evidence of the original entrances or fire places due to subsequent rebuilding. It is possible that service accommodation was at the west end of the hall. The inglenook fireplace and door on the north wall are mid 17th century. There was stone barn to the east with a re sighted date stone 1691 and the initials RDP. This is now above the door to the barn to the west.

East Wall







The stone earthen bank to the south and east of the building could indicate a medieval manorial site which is in keeping with other sites around the country.







The Heys Family

James Heys was born 1703, he married Susanna.

Children

James Heys, b. 1732, d. 1776.

Richard Heys born 1736 and died 1812 at Dearden Fold. He married Hannah Kirkman on
September 10, 1769.

Children

John Heys, b. October 11, 1771, d. February 1775.

Richard Heys, b. July 1777, d. September 1782.

Thomas Heys, b. April 18, 1783 d. December 9, 1862.

William Heys, b. August 1780, d. 1835.

Abraham Heys, b. September 18, 1785, d. March 1790.

Joseph Heys, b. July 10, 1792, d. September 24, 1860.

Betty Heys, b. date unknown, d. date unknown.

Susanna Heys, b. date unknown, d. date unknown.

It looks like you have local storage disabled. While you'll still be able to use the site, you may notice that pages load more slowly. [Fix the issue.](#)

1841 England Census for Mary Kerkman

SAVE

PLACE	of each Person who shall therein the preceding Night	Males	Females	or of INDEPENDENT MEANS	of each Person who shall therein the preceding Night	Males	Females	or of INDEPENDENT MEANS
<i>Widow</i>	<i>Mary Kerkman</i>		<i>1</i>	<i>Widow</i>	<i>Mary Kerkman</i>		<i>1</i>	<i>Widow</i>
	<i>John D</i>	<i>10</i>		<i>Widow</i>	<i>Louise Bay</i>	<i>50</i>		<i>Widow</i>
	<i>Mary D</i>	<i>8</i>		<i>Widow</i>	<i>John D</i>	<i>12</i>		<i>Widow</i>
	<i>John D</i>	<i>6</i>		<i>Widow</i>	<i>Mary D</i>	<i>12</i>		<i>Widow</i>
	<i>Mary D</i>	<i>5</i>		<i>Widow</i>	<i>John D</i>	<i>6</i>		<i>Widow</i>
	<i>Robert D</i>	<i>12</i>		<i>Widow</i>	<i>Mary D</i>	<i>6</i>		<i>Widow</i>
<i>Remans</i>	<i>Widow</i>			<i>Widow</i>	<i>John D</i>			<i>Widow</i>
	<i>Mary D</i>		<i>12</i>	<i>Widow</i>	<i>Mary D</i>	<i>11</i>		<i>Widow</i>
	<i>John D</i>	<i>20</i>		<i>Widow</i>	<i>John D</i>	<i>50</i>		<i>Widow</i>
	<i>Mary D</i>	<i>15</i>		<i>Widow</i>	<i>Mary D</i>	<i>11</i>		<i>Widow</i>
	<i>John D</i>	<i>10</i>		<i>Widow</i>	<i>John D</i>	<i>10</i>		<i>Widow</i>
	<i>John D</i>	<i>10</i>		<i>Widow</i>	<i>Mary D</i>	<i>12</i>		<i>Widow</i>
<i>No</i>	<i>Mary D</i>			<i>Widow</i>	<i>John D</i>	<i>11</i>		<i>Widow</i>
	<i>Mary D</i>		<i>10</i>	<i>Widow</i>	<i>John D</i>	<i>11</i>		<i>Widow</i>
	<i>John D</i>	<i>20</i>		<i>Widow</i>	<i>Mary D</i>	<i>35</i>		<i>Widow</i>
	<i>John D</i>	<i>15</i>		<i>Widow</i>	<i>John D</i>	<i>15</i>		<i>Widow</i>
	<i>Mary D</i>	<i>12</i>		<i>Widow</i>	<i>John D</i>	<i>14</i>		<i>Widow</i>
	<i>John D</i>	<i>8</i>		<i>Widow</i>	<i>John D</i>	<i>10</i>		<i>Widow</i>
	<i>John D</i>	<i>6</i>		<i>Widow</i>	<i>John D</i>	<i>10</i>		<i>Widow</i>
	<i>John D</i>		<i>6</i>	<i>Widow</i>	<i>John D</i>	<i>4</i>		<i>Widow</i>
	<i>John D</i>		<i>2</i>	<i>Widow</i>	<i>John D</i>	<i>10</i>		<i>Widow</i>
	<i>John D</i>			<i>Widow</i>	<i>John D</i>	<i>20</i>		<i>Widow</i>
	<i>John D</i>			<i>Widow</i>	<i>John D</i>	<i>10</i>		<i>Widow</i>
TOTAL in Page 14								
		<i>10</i>	<i>11</i>					

HO 107 / 544 / 1

HO 107 / 544 / 1

It looks like you have local storage disabled. While you'll still be able to use the site, you may notice that pages load more slowly. [Fix the issue.](#)

1851 England Census for Joseph Heys

SAVE

Parish or Township of		Ecclesiastical District of		City or Borough of		Town of		Village of	
Ainsworth		Ancient Chapel of Ainsworth							
Name of Street, Place, or Road, and Name or No. of House	Name and Surname of each Person who abode in the house, on the Night of the 30th March, 1851	Relation to Head of Family	Condition	Age of		Rank, Profession, or Occupation	Where Born		Whether Blind, or Deaf and Dumb
				Males	Females				
142	Scardam Fold	Joseph Heys	Head	Male	46	Farmer of 56 acres	Sant.	Ainsworth	
	Harrold St.	Hannah Heys	Wife	Female	38	Spinster	Sant.	Sant.	
	St.	Martha Heys	Daughter	Female	26	Do. Do.	Sant.	Sant.	
	St.	Abraham Heys	Son	Male	24	Do. Son	Sant.	Sant.	
	St.	Joseph Heys	Son	Male	16	Do. Servant	Sant.	Sant.	
	St.	Lidia Heys	Daughter	Female	13	Do. Do.	Sant.	Sant.	
	St.	Michael Leuzman	Servant	Male	45	Domestic Servant	Wales	Wales	
				Total of Persons		3			

PUBLIC RECORD OFFICE

Reference: H O 107/2215

COPYRIGHT PHOTOGRAPH—NOT TO BE REPRODUCED PHOTOGRAPHICALLY WITHOUT PERMISSION OF THE PUBLIC RECORD OFFICE, LONDON

1861 England Census

SAVE

The undermentioned Houses are situate within the Boundaries of the 78^{sc} 3

Parish (or Township) of		City or Municipal Borough of		Municipal Ward of		Parliamentary Borough of		Town of		Hamlet or Tything, &c., of		Ecclesiastical District of	
Amersforth												Christchurch	
No. of Schedule	Road, Street, &c., and No. or Name of House	HOUSES		Name and Surname of each Person	Relation to Head of Family	Condition	Age of		Rank, Profession, or Occupation	Where Born	Whether Blind, or Deaf and Dumb		
		In	Existence				Male	Female					
9	Little Acre			William Brooks	Head			41		Knave	Amersforth		
				Mrs. Thomas	Wife			50			Amersforth		
				John Gregory	Shipman			11		Carton Weaver	Amersforth		
				Elizabeth				10		Schooler	Amersforth		
10	Warden Fold	1		William King	Carton	100		27		James of Amers	Amersforth		
				Harriet	Wife	100		26		Amersforth			
				John		100		22		Amersforth			
11	Ball Fold	1		William Gordon	Footman	100		55		Amersforth			
				Joseph Campbell	Head	100		44		Blacksmith	Amersforth		
				John	Wife	100		46		Amersforth			
				Stephen	Son	100		9		Schooler	Amersforth		
				Joseph	Son	100		20		Amersforth			
12	Green Fold	1		George King	Head	100		28		Carrier	Amersforth		
				Robert	Wife	100		25		Amersforth			
				William King	Son	100		11		Schooler	Amersforth		
				John	Son	100		4		Amersforth			
				George	Son	100		14		Amersforth			
				William King	Son	100		14		Carton	Amersforth		
				George	Son	100		14		Carton	Amersforth		
13		1		Joseph Brooks	Head	100		44		Carton	Amersforth		
				Elizabeth	Wife	100		42		Amersforth			
				John	Son	100		13		Amersforth			
				Thomas	Son	100		11		Amersforth			
				Thomas	Son	100		11		Blacksmith	Amersforth		

PUBLIC RECORD OFFICE
 R.G. 9 / 2853
 COPYRIGHT PHOTOGRAPH - NOT TO BE REPRODUCED WITHOUT PERMISSION OF THE PUBLIC RECORD OFFICE, LONDON

The National Archives

© 1997-2016 Ancestry.com

Filmstrip



It looks like you have local storage disabled. While you'll still be able to use the site, you may notice that pages load more slowly. [Fix the issue.](#)

1881 England Census

SAVE

The undermentioned Houses are situate within the Boundaries of the

Page 2]		Civil Parish (or Township) of					City or Municipal Borough of		Municipal Ward of		Parliamentary Borough of		Town or Village or Hamlet of		Urban Sanitary District of		Rural Sanitary District of		Ecclesiastical Parish or District of	
		Ainsworth													Bury		Christ Church, Ainsworth			
No. of Households	ROAD, STREET, &c., and No. or NAME of HOUSE	HOUSES		NAME and Surname of each Person	RELATION to Head of Family	CON-DITION as to Marriage	AGE last Birthday of		Rank, Profession, or OCCUPATION	WHERE BORN		(1) Deaf and dumb (2) Blind (3) Imbecile or idiot (4) Lunatic								
		In-cluded in (A)	Ex-cluded in (B)				Males	Females												
6	Bollon Old Moor	1	1	Elizabeth A. Boulton	Wife	—		2			Radcliffe, Lancashire									
				Thomas do	Son	—	1				do do									
7	do	1	1	Ann Kirkman	Wife	—		30	Employed at Bleach Works		Ainsworth Lane									
				John S. Whittle	Nephew	do	18		Bleacher	do	do do									
				James Lee	Sister	Mar		40	Cotton Weaver		Tongworth	do								
				Annie Lee	Wife	—		8	Scholar		Ainsworth	do								
8	do	1	1	Alfred Platt	Head	Mar		27	Coal Miner		do do									
				Sarah A. do	Wife	do		32	Cotton Weaver		Harwood	do								
				Thomas do	Son	—		6			Ainsworth	do								
				John do	do	—		3			do do									
9	do	1	1	Joseph Hays	Head	Mar		56	Farmer 58 Acres		do do									
10	Hearden Fold	1	1	Hannah do	Wife	do		52			Bollon	do								
				Peter J. do	Son	Mar		23	Farmer's Son		Ainsworth	do								
				Martha A. do	Wife	do		19	Daughter		do do									
				Mary L. do	do	do		16	do		do do									
11	do	1	1	Amos Brooks	Head	Mar		45	Baker out of work		do do									
12	Bull Fold	1	1	Mary do	Wife	do		40			Walmley	do								
				James do	Son	Mar		19	Labourer at Tile Works		Ainsworth	do								
				Sarah do	Wife	do		18	Cotton Yarn Winder		do do									
				Alice do	do	do		16	do		do do									
				William do	Son	do		10	Farmer's Boy Servant		do do									
				John do	do	—		9	Scholar		do do									
				Amos do	do	—		7	do		do do									
Total of Houses...		4	23	Total of Males and Females...				12	11											

NOTE.—Draw the pen through such of the words of the headings as are inappropriate.

It looks like you have local storage disabled. While you'll still be able to use the site, you may notice that pages load more slowly. [Fix the issue.](#)

1891 England Census

SAVE

Administrative County of Leicestershire
 Civil Parish of Hinsworth
 Municipal Borough of Hinsworth
 Municipal Ward of Hinsworth
 Urban Sanitary District of Hinsworth
 The undermentioned Houses are situate within the Boundaries of the
 Township of Hinsworth in the Parish of Hinsworth in the County of Leicestershire
 Parliamentary Borough of Hinsworth in the County of Leicestershire
 Ecclesiastical Parish of Hinsworth

Page 14

No. of Household	ROAD, STREET, Lane, and No. or NAME of HOUSE	ROOFS	No. of Rooms	NAME and Locality of each Person	RELATION to Head of Family	CON. MARRIAGE	AGE last Birthday or Date of Birth	SEX	PROFESSION or OCCUPATION	WHERE BORN			(1) England & Wales (2) Ireland (3) Foreign, British or Irish
										Male	Female	Other	
85	19	1	1	Peter A. Horrocks	Head	M	24	M	Wagon Driver				Leicestershire - Hinsworth
85	21	1	1	Abraham Horrocks	Head	M	62	M					" "
				Ann	Wife	M	62	F					" "
86	23	1	4	Sebel Booth	Head	M	36	M	Wagon Driver				" "
				Ann	Wife	M	36	F					" "
				Elizabeth A.	Daughter	F	15	F					" "
				Miriam I.	Daughter	F	11	F					" "
				William A.	Son	M	8	M					" "
				Mary	Daughter	F	5	F					" "
				John A.	Son	M	5	M					" "
87	24	1	4	Abraham Booth	Head	M	53	M	Wagon Driver				" "
				Ann	Wife	M	52	F					" "
				Margaret	Daughter	F	24	F					" "
				Ann	Daughter	F	21	F					" "
				John	Son	M	10	M					" "
				Elizabeth	Daughter	F	10	F					" "
				John	Son	M	2	M					" "
88	25	1	1	George Leigh	Head	M	76	M	Farmer				" "
				Joseph	Head	M	65	M					" "
				Margaret	Wife	M	62	F					" "
89	26	1	3	Mary J.	Head	F	25	F	Wagon Driver				" "
				John J.	Head	M	33	M	Wagon Driver				" "
				Ruth	Wife	M	29	F					" "
				William	Daughter	F	24	F					" "
				Joseph	Son	M	21	M					" "
				William	Son	M	18	M					" "
				Walter	Son	M	13	M					" "

Total of Houses and of Tenements with less than Five Rooms: 5 28 11

Total of Males and Females: 13 15

NOTE.—Draw the pen through such of the words of the headings as are inappropriate.